

## 2.3 Exporting & Importing a Playlist

Once you have created a playlist, you can export it as a file onto either your local storage or into an external storage device which will automatically play when connected to a Novo device. Follow the steps below to export your playlist:

- In the main DS Playlist, screen mouse over the playlist you want to export and click the export button at the top-left corner of the playlist preview.

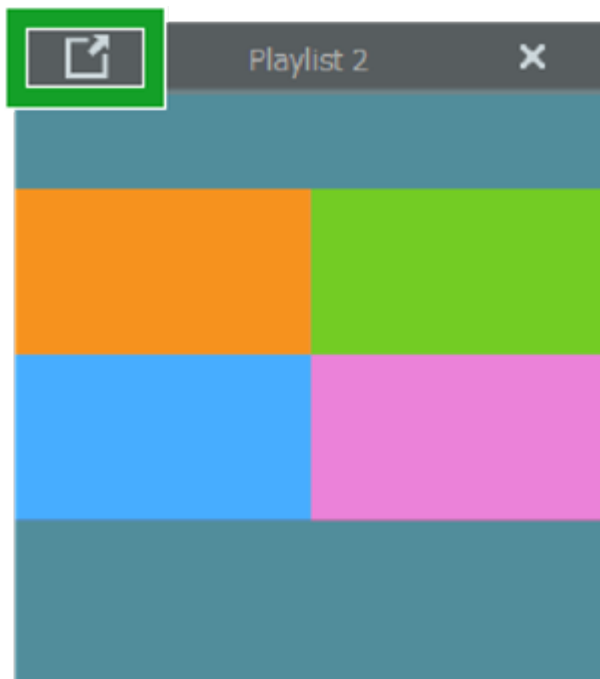

- In the **Export Playlist** menu, select one of the following options:
  - **Regular playlist package (for import)** – Saves the playlist as an .npl2 file onto your local storage.
  - **Auto-start playlist for external storage** – Saves the playlist onto an external device which will automatically play once connected to a Novo device.
  - **Auto-start playlist for external storage (clean up and duplicate a new one)** – Overrides the playlist

on an external device with the selected playlist.

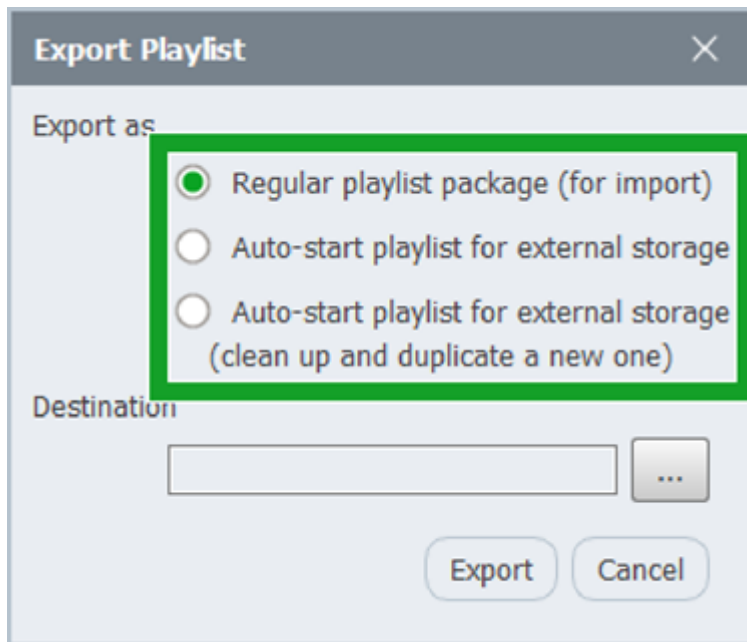

- In the **Destination** field, click the more button (...) and navigate to the local folder or external drive where you want to save the playlist.

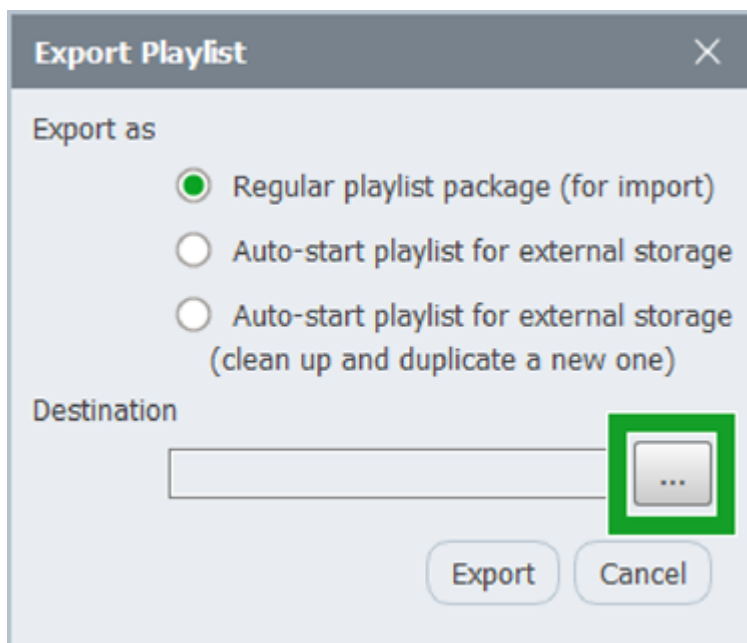

- Click **Export**.

## Import a Playlist

To import a playlist that has been saved on your local storage, click the **Import** button at the top-right corner of the main DS Playlist screen, and then select the .npl2 file on your local storage.

