

3.12 Turn Wi-Fi Off and On

1. Enter the NovoTouch home screen and tap the button at the bottom to enter the All Apps menu.

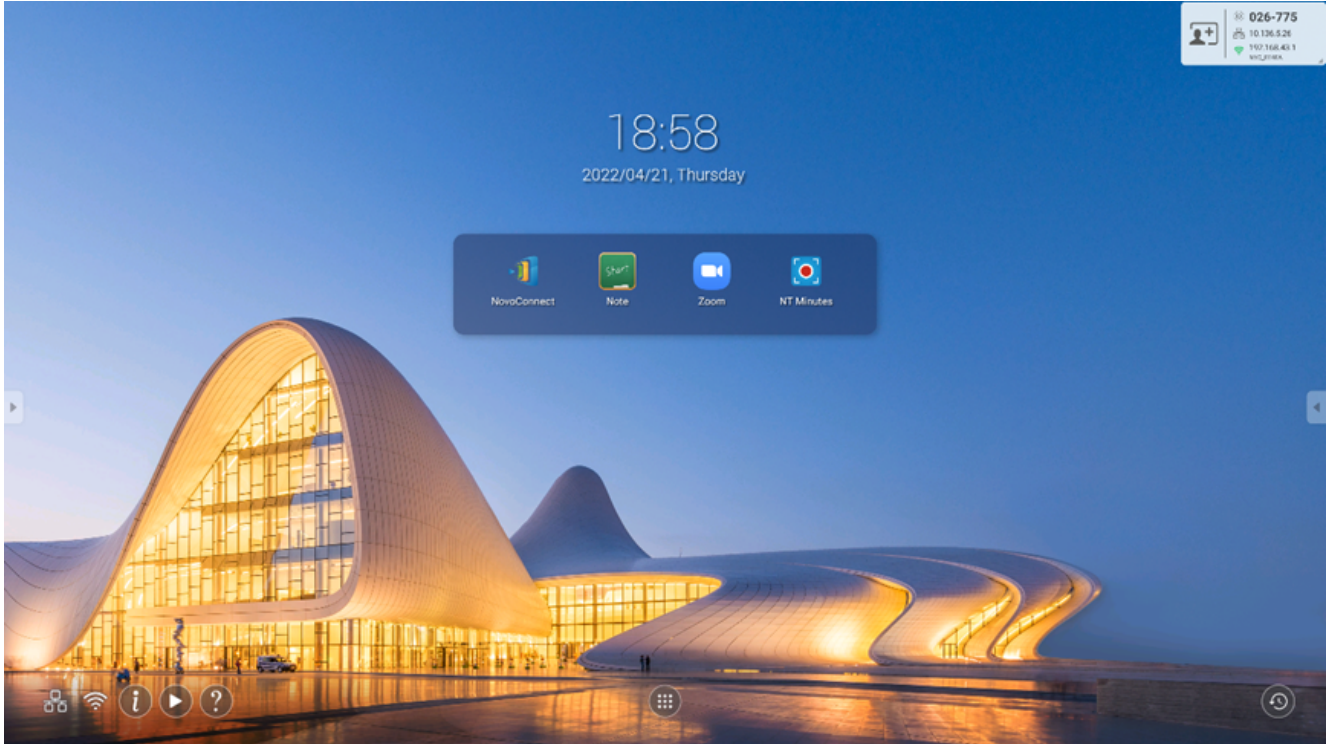

2. Tap **NT Settings**.

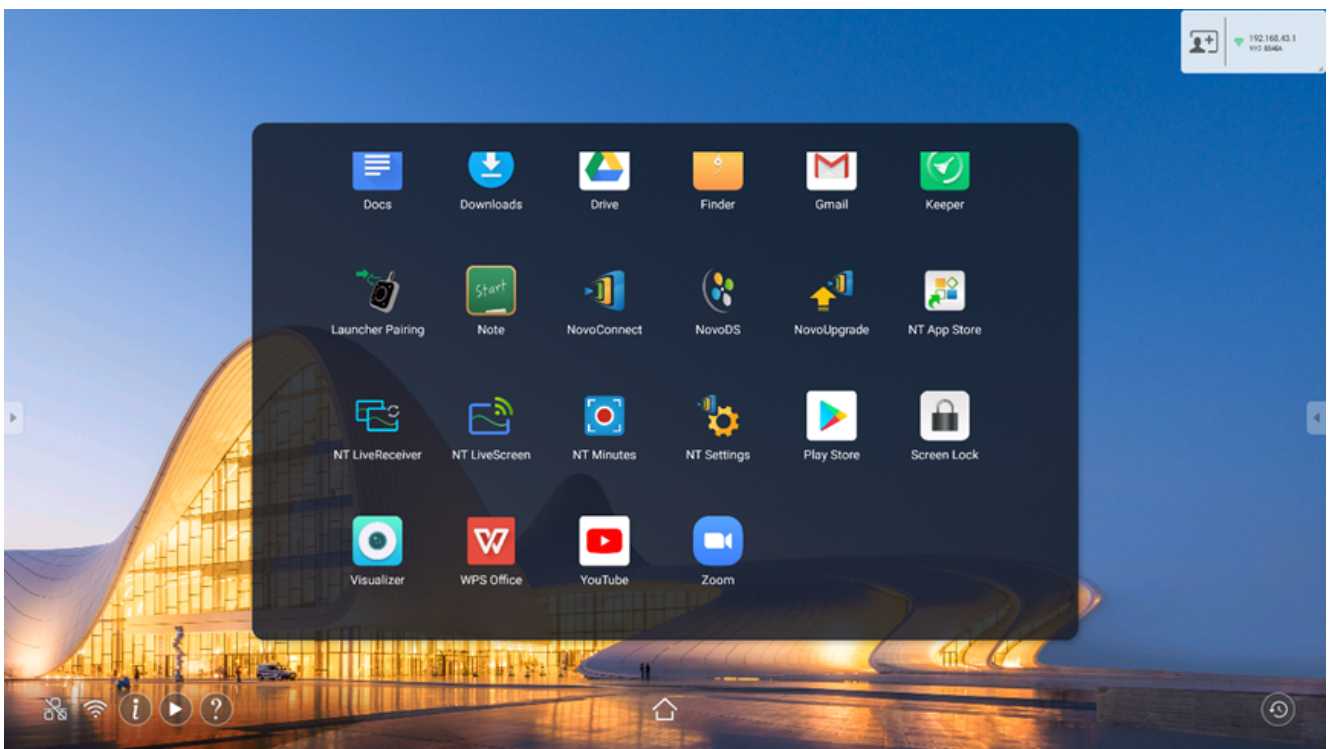

3. Tap **Wi-Fi**.

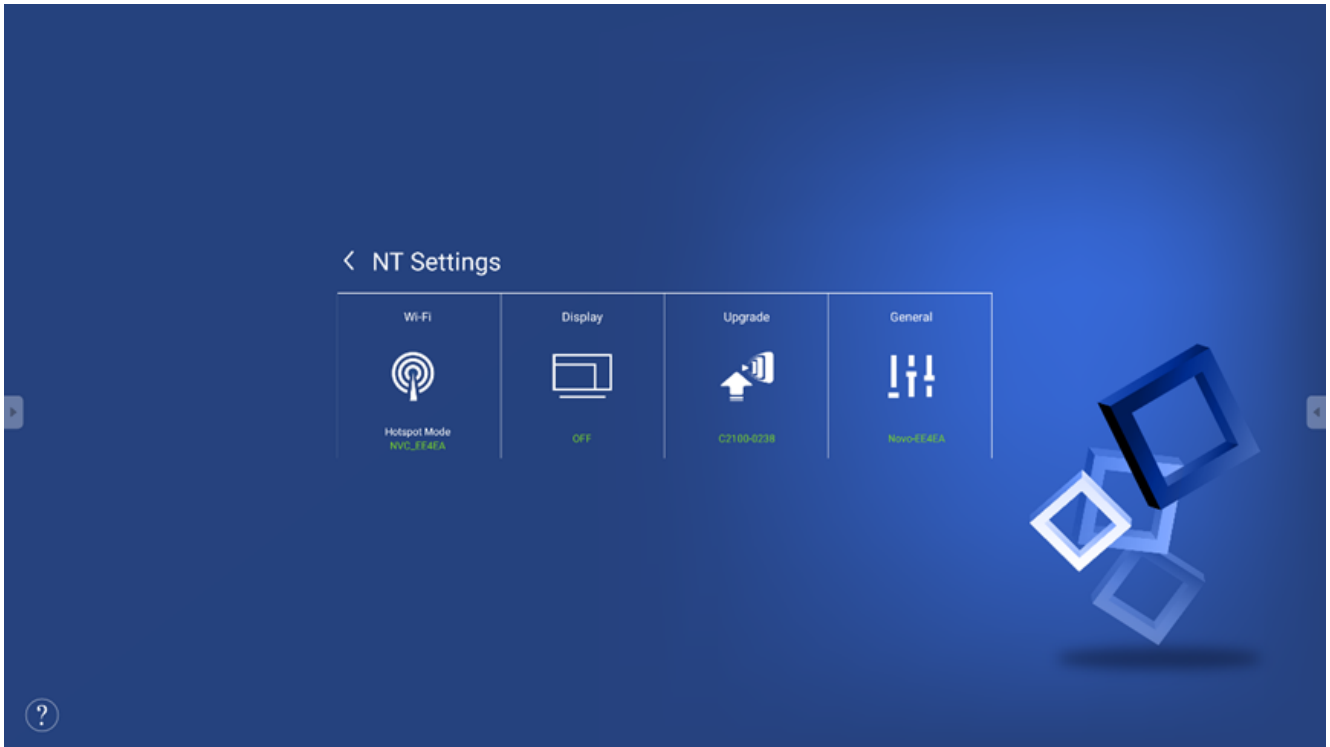

4. Select **Connect to Wi-Fi**, and then tap **Configure**.

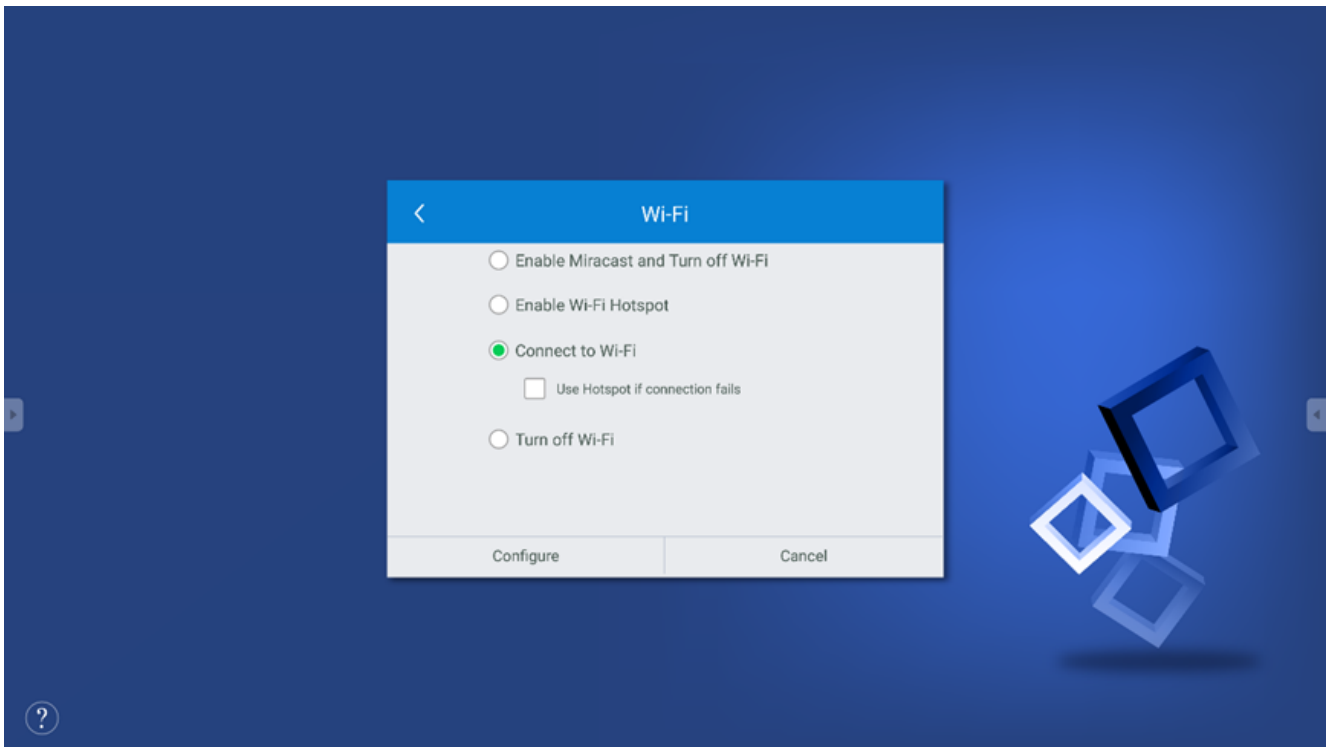

5. In the **Select Wi-Fi** menu, select the Wi-Fi SSID you want to connect to.

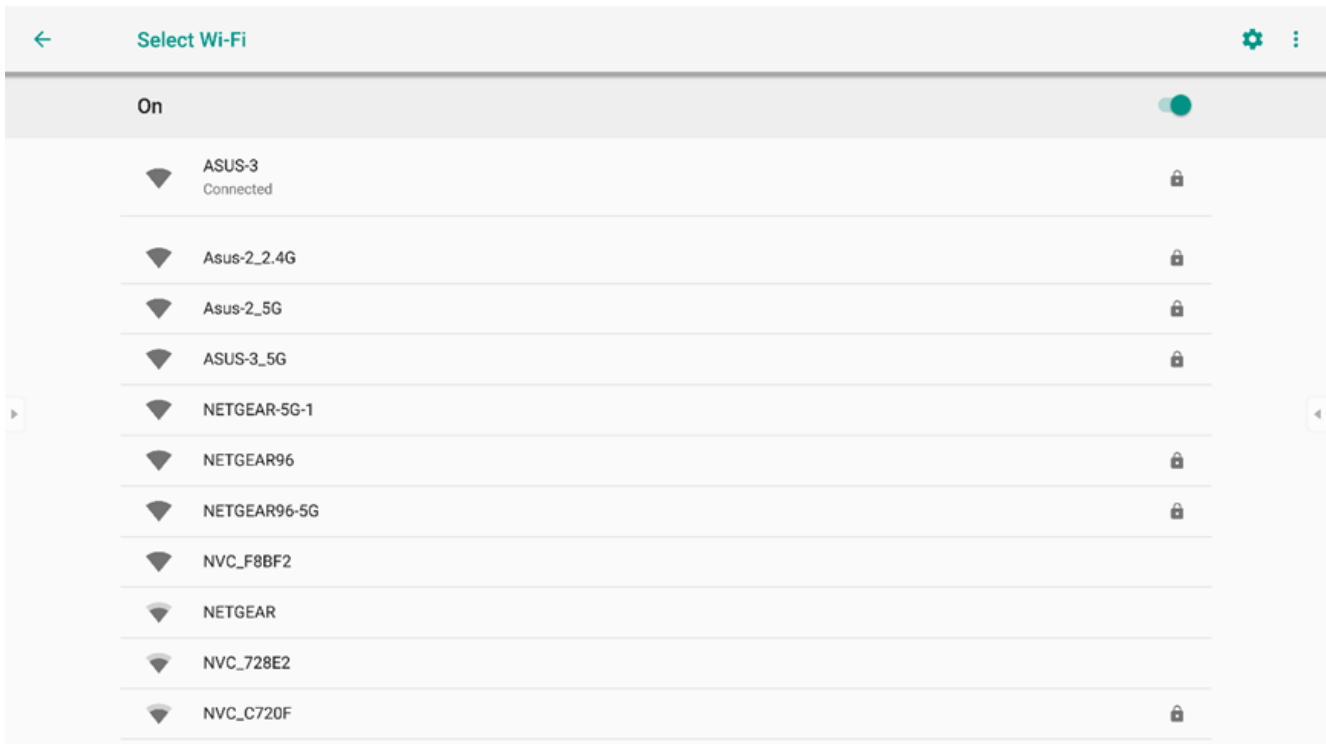

6. In the **Wi-Fi** menu, select **Turn off Wi-Fi** and then tap **Apply**.

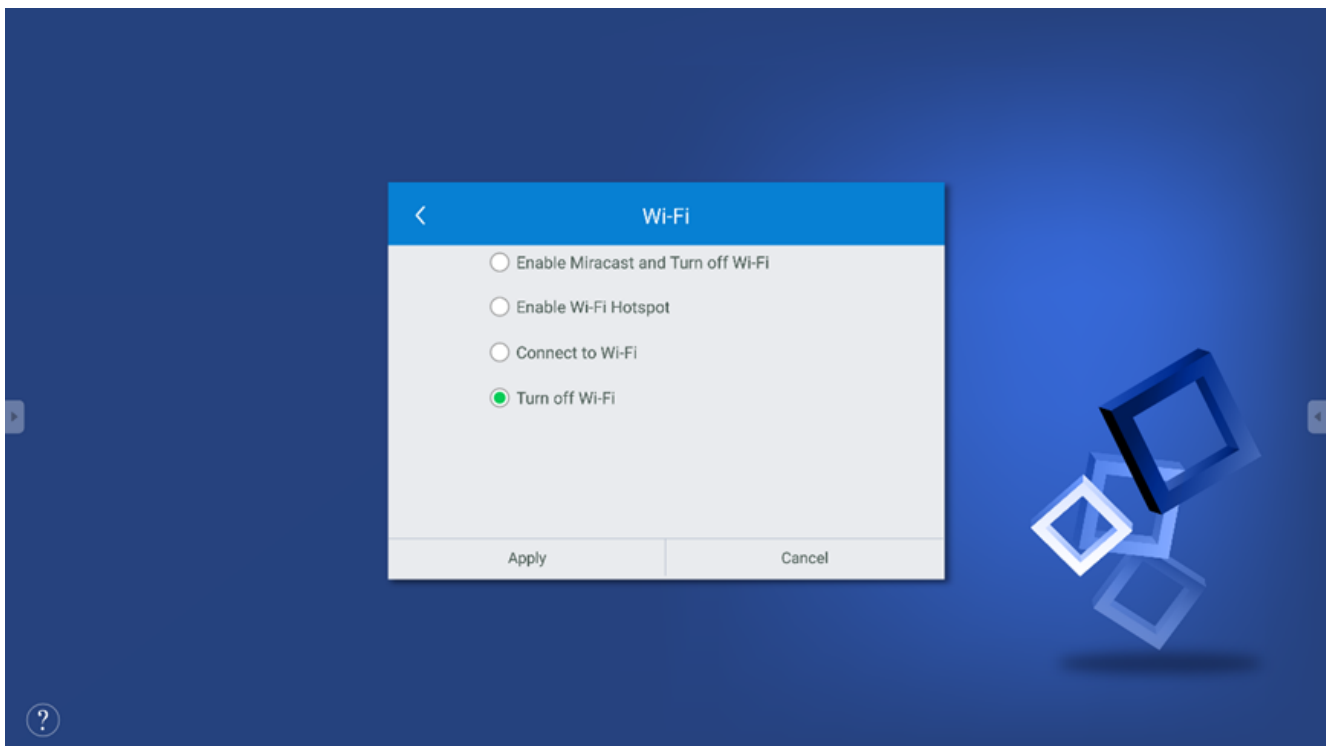

7. Return to the **NT Settings** menu, and the **Wi-Fi** option will be shown as **Disabled**.

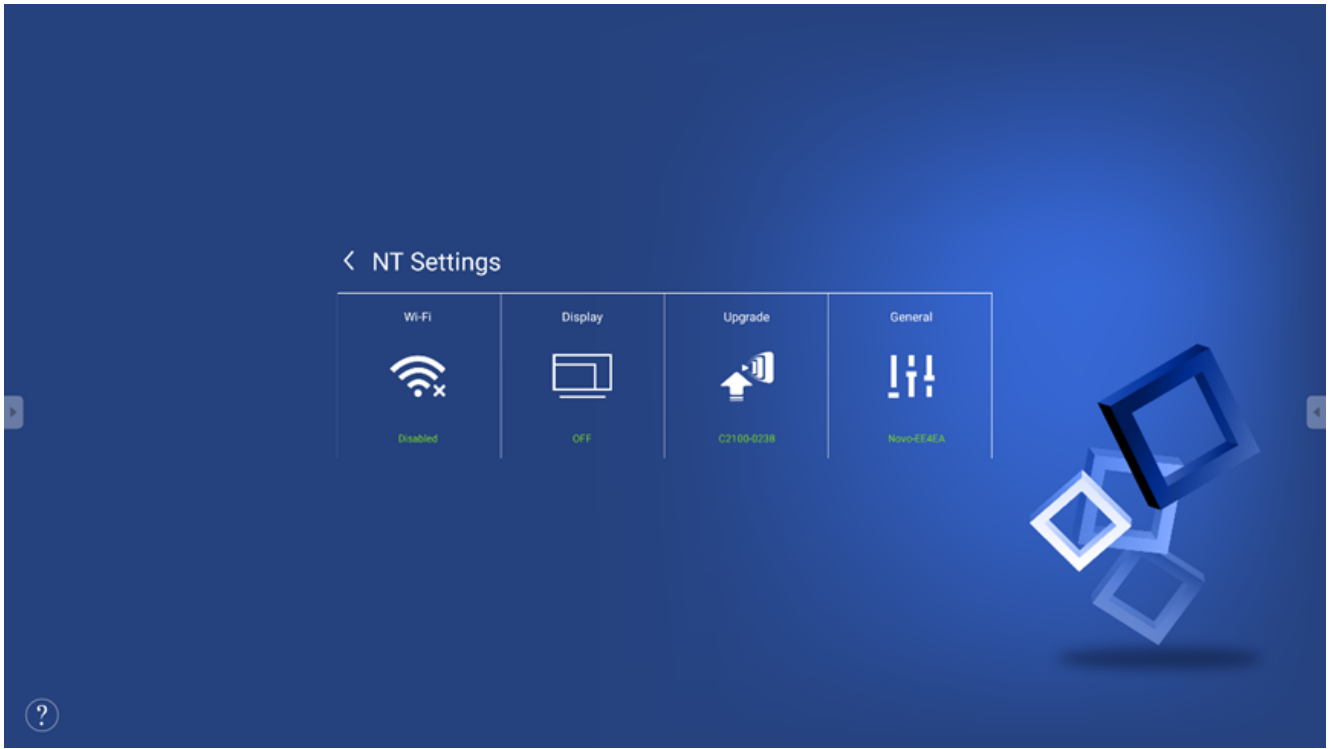

- ☰
- <
- >
- 🔗