

# 1.4 Accessories

The following accessories are optional for you to use NovoDisplay.

## (1) OPS Module

Users can plug in an OPS module to further enhance NovoDisplay's capability.

Typically you can install Windows or Linux on Intel x86-based OPS and you can run any desktop applications on NovoDisplay immediately.

## (2) LauncherPlus & LauncherOne

NovoDisplay supports LauncherPlus and LauncherOne.

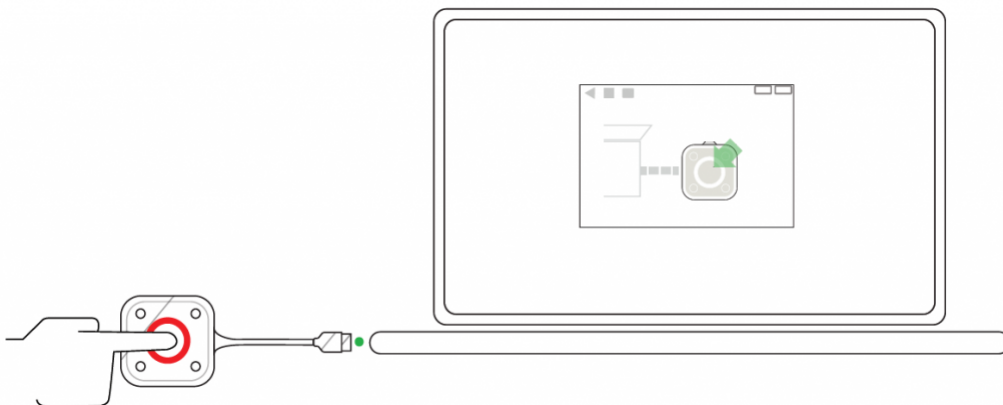

Connecting a Launcher unit to your computer

- LauncherPlus

LauncherPlus establishes a direct WiFi connection from your computer to any NovoConnect devices. Intended for guests, LauncherPlus streamlines and secures the connection process, with zero impact on the existing network.

- LauncherOne

LauncherOne is specifically designed for companies with strict Data Loss Prevention (DLP) and IT security policies that lock

USB ports for storage devices and do not allow corporate network-based wireless presentation solutions. LauncherOne includes a physical HID device and a portable application file. No administrator rights needed.

